

Reference No. PLS00074

DEVELOPER **EMAAR**

Invest in Premium Living | Resort-Style Amenities | Building 2

Starting from **₹ 1,500,000**

Club Drive at Dubai Hills Estate - Dubai - United Arab Emirates [VIEW IN MAP](#)

Payment Plan 10/80/10	Handover From Q4 2027	Location Club Drive at Dubai ...	Property Type Apartment	DLD Fee 4 %
---------------------------------	---------------------------------	--	-----------------------------------	-----------------------

Description:

Club Drive, Building 2 by **Emaar Properties** is an exquisite residential development situated in the vibrant and meticulously planned **Dubai Hills Estate**, a community renowned for its lush greenery, wide boulevards, and world-class lifestyle amenities. This elegant project comprises two mid-rise towers offering **1, 2, and 3 bedroom apartments** designed with contemporary architecture, open layouts, and premium finishes, ensuring a perfect blend of style, comfort, and functionality.

Each apartment features spacious living areas, modern kitchens, and large windows that invite natural light while offering **stunning views of the championship golf course, landscaped gardens, and Dubai skyline**. Residents can indulge in a wide array of **resort-style amenities**, including an infinity pool, fully equipped gym, children’s play areas, landscaped podium gardens, social lounges, and multipurpose spaces, fostering a vibrant community lifestyle.

Download the **Prosper App**

Strategically located, the development provides **excellent connectivity to Downtown Dubai, Dubai Marina, major road networks, premium schools, healthcare facilities, and retail destinations**, allowing residents to enjoy both convenience and serenity. With its thoughtfully crafted spaces, scenic surroundings, and access to world-class facilities, Club Drive, Building 2 represents an **ideal investment opportunity and a sophisticated, modern lifestyle choice** for families, professionals, and discerning investors looking to embrace the best of Dubai living.

Amenities

- Swimming Pool
- Gym | Fitness Center
- Kids Play Area
- BBQ Area
- Multipurpose Hall
- 24/7 Security & CCTV
- High-speed Elevators
- Smart Home Integration
- Pet-friendly Zones
- Supermarket / Store
- Restaurants | Cafés
- Gardens | Parks
- Jogging | Cycling Track
- Yoga | Pilates Studio
- Concierge Services
- Maid's Room
- Sports Courts
- Clubhouse | Community Center
- Parking

Payment Plan

INSTALMENT	PERIOD	DATE	BOOKING AMOUNT %
Down Payment	Immediate	-	10
1	After Booking	31-12-2023	10
2	After Booking	30-04-2024	10
3	After Booking	31-08-2024	10

Download the **Prosper App**



INSTALMENT	PERIOD	DATE	BOOKING AMOUNT %
4	After Booking	31-01-2025	5
5	After Booking	30-11-2025	15
6	After Booking	30-06-2026	10
7	After Booking	31-12-2026	10
8	After Booking	31-07-2027	10
9	On Completion	-	10

Regulatory Information

Permit Number:	0186780055
DED:	771800
RERA:	143033
BRN:	40659

Trakheesi Permit:



[more photos](#)

Download the **Prosper App**



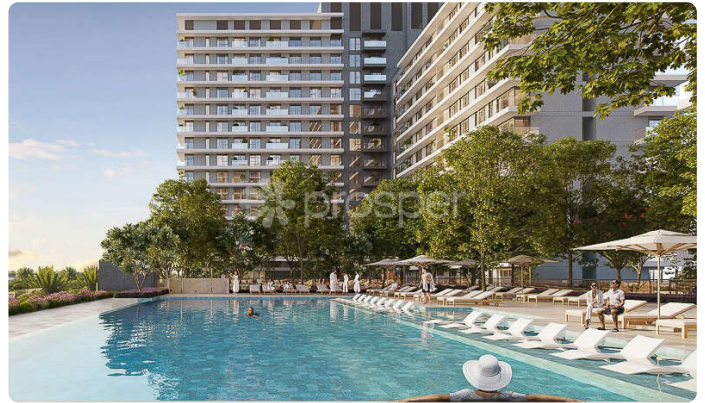
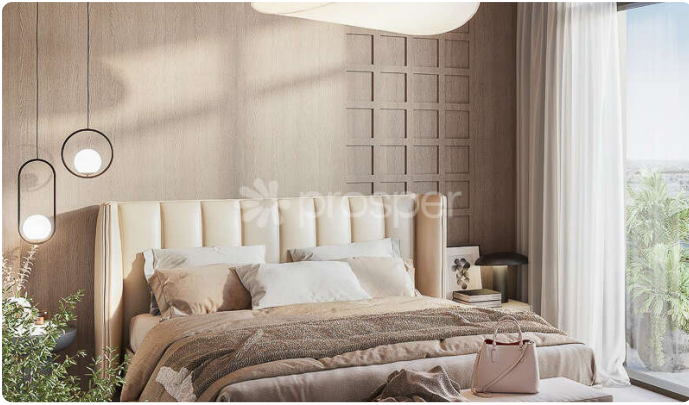

Download the Prosper App





Unit Types

View units which comes under this project.

Apartment

TYPE	BEDROOM	AREA (SQFT)	PRICE	
1 BEDROOM - TYPE 1A/1B	1	Built Up: 700 - 724	₹ 1,500,000	
1 BEDROOM - TYPE 2	1	Built Up: 700 - 724	₹ 1,500,000	
1 BEDROOM - TYPE 3	1	Built Up: 700 - 724	₹ 1,500,000	
1 BEDROOM - TYPE 4	1	Built Up: 700 - 724	₹ 1,500,000	
2 BEDROOM - TYPE 1/TYPE 2	2	Built Up: 1050 - 1079	₹ 2,200,000	
2 BEDROOM - TYPE 3A/TYPE 3B	2	Built Up: 1050 - 1079	₹ 2,200,000	
2 BEDROOM - TYPE 4	2	Built Up: 1050 - 1079	₹ 2,200,000	

Download the **Prosper App**



TYPE 3 BEDROOM - TYPE 1	BEDROOM 3	AREA (SQFT) Built Up: 1530 - 1561	PRICE  3,400,000	
TYPE 3 BEDROOM - TYPE 2	BEDROOM 3	AREA (SQFT) Built Up: 1530 - 1561	PRICE  3,400,000	
TYPE 3 BEDROOM - TYPE 3	BEDROOM 3	AREA (SQFT) Built Up: 1530 - 1561	PRICE  3,400,000	

Download the **Prosper App**

