









Reference No. **PLS00044**

DEVELOPER  **BINGHATTI**
بن غاطي

Modern Living | Contemporary Design | Flexible Plans

Starting from **₹ 774,999**

 **Binghatti Hillside - Dubai - United Arab Emirates** [VIEW IN MAP ↗](#)



 Payment Plan 70/30	 Handover From Q3 2026	 Location Binghatti Hillside - ...	 Property Type Apartment	 DLD Fee 4 %
--	---	---	---	---

Description:

Binghatti Hillside is an innovative residential development strategically located in **Dubai Science Park**, Al Barsha South, Dubai designed to combine modern living with a serene, community-focused environment. The project features a striking hill-inspired architectural design with flowing lines and landscaped podiums, offering a visually appealing aesthetic that stands out in Dubai's skyline. The tower comprises 402 thoughtfully planned units, including 320 studios and 82 one-bedroom apartments, along with nine retail spaces on the ground floor, catering to both residential and lifestyle needs. Each apartment is finished with premium materials such as wood, marble, and porcelain, reflecting Binghatti Developers' commitment to quality and sophistication.

Residents at Binghatti Hillside have access to a comprehensive range of amenities designed for relaxation, wellness, and recreation. These include adult and kids' swimming pools with horizon-edge designs, splash zones, separate male and female gyms, yoga and meditation zones, half basketball courts, landscaped gardens, BBQ decks, and children's play areas. The development also offers concierge services and business lounges, creating a seamless blend of comfort, convenience, and lifestyle. Its location in Dubai Science Park ensures excellent connectivity to major roads,

Download the **Prosper App**



nearby shopping centers like Mall of the Emirates, healthcare facilities, and recreational hubs such as Dubai Hills Golf Club.

With flexible payment plans, freehold ownership, and an attractive projected rental yield, Binghatti Hillside presents a compelling investment opportunity for both end-users and investors. The project is particularly suited for young professionals, small households, and those seeking modern, off-plan apartments in a thriving innovation hub. Expected for completion in Q2 2026, Binghatti Hillside offers not only a premium living experience but also a strategic investment in one of Dubai's most sought-after locations.

Amenities

Swimming Pool	Concierge Services	24/7 Security & CCTV
Co-working Business Lounge	Spa Sauna Steam	Kids Play Area
Gym Fitness Center	BBQ Area	Smart Home Integration
High-speed Elevators	Pet-friendly Zones	Jogging Cycling Track
Valet Parking	Gardens Parks	Supermarket / Store
Restaurants Cafés	Sports Courts	Clubhouse Community Center
Yoga Pilates Studio		

Payment Plan

INSTALMENT	PERIOD	DATE	BOOKING AMOUNT %
1	After Booking	12-11-2025	20
2	After Booking	10-02-2026	25

Download the **Prosper App**



INSTALMENT	PERIOD	DATE	BOOKING AMOUNT %
3	After Booking	10-05-2026	25
4	On Completion	-	30

Regulatory Information

Permit Number: **0255183697**

DED: **771800**

RERA: **143033**

BRN: **40659**

Trakheesi Permit:



more photos

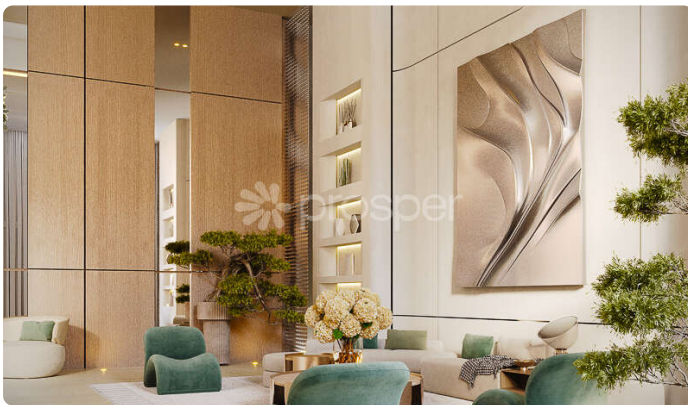

Download the Prosper App



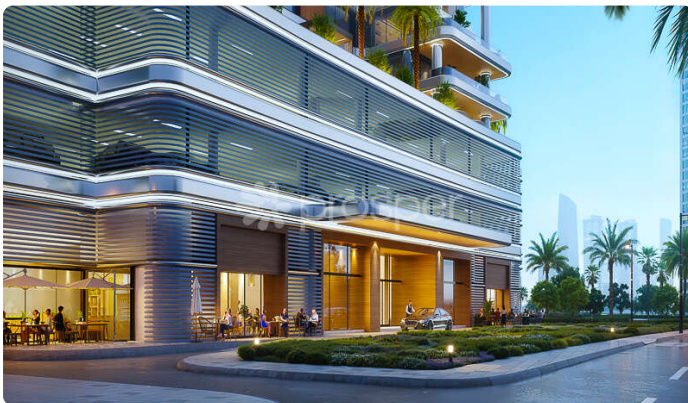







Unit Types

View units which comes under this project.

Download the Prosper App



Apartment

TYPE	BEDROOM	AREA (SQFT)	PRICE	
STUDIO - TYPE 01	0	Built Up: 310 - 359	₹ 774,999	
STUDIO - TYPE 02	0	Built Up: 310 - 359	₹ 774,999	
1 BEDROOM - TYPE 01	1	Built Up: 855 - 1340	₹ 1,150,000	
1 BEDROOM - TYPE 02	1	Built Up: 855 - 1340	₹ 1,150,000	
1 BEDROOM - TYPE 03	1	Built Up: 855 - 1340	₹ 1,150,000	
1 BEDROOM - TYPE 05	1	Built Up: 855 - 1340	₹ 1,150,000	

Download the Prosper App

